



THERMO KING

Imprimante TouchPrint

Mode d'emploi

TouchPrint Printer

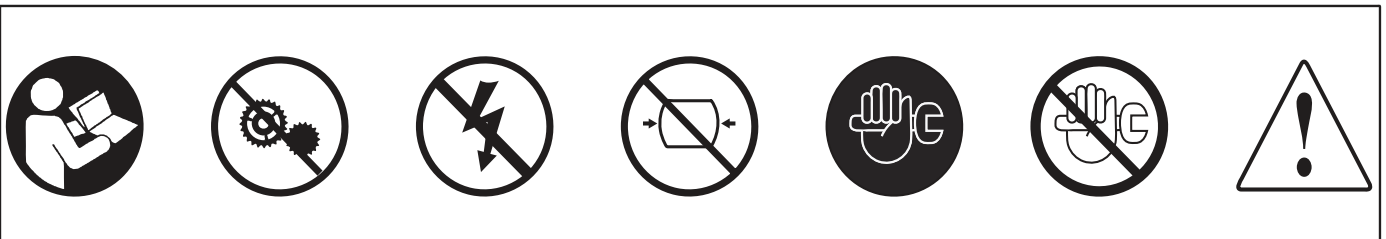
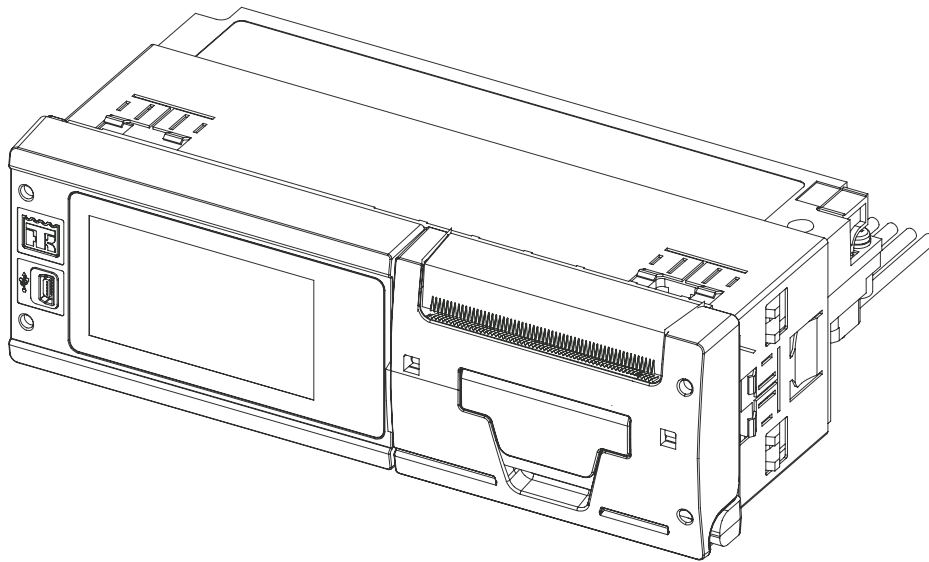

1. Changer le rouleau de papier

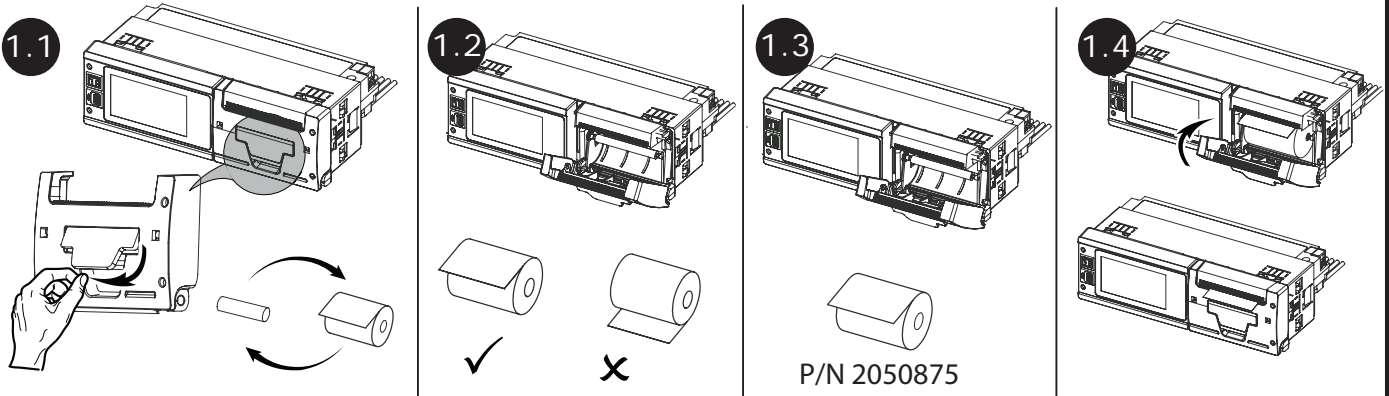

2. Opérations de base

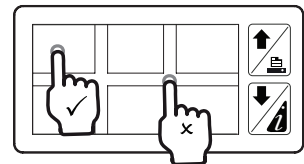
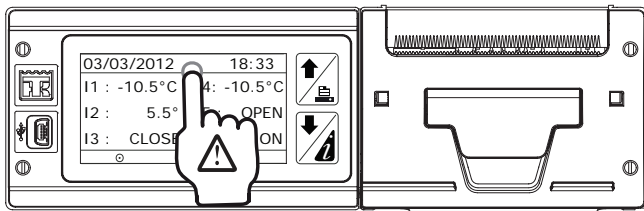

8 Buttons



Quick Print



Quick Info

3. Menu principal

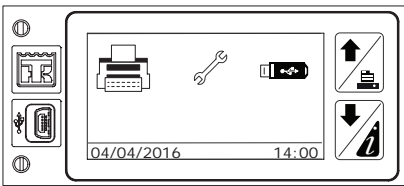

Print Menu



USB - not connected



User Menu



USB - connected

4. Menu d'impression

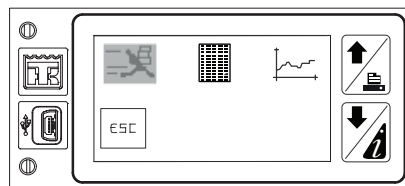
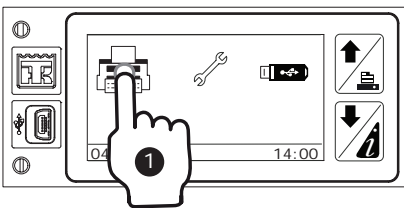

Delivery Ticket



Trip Ticket



Journey Ticket Graph

4.1 Imprimer un ticket de livraison

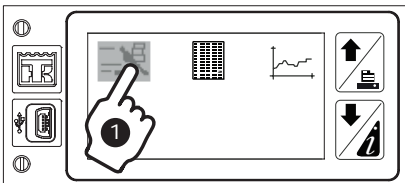

4.2 Imprimer un ticket de trajet

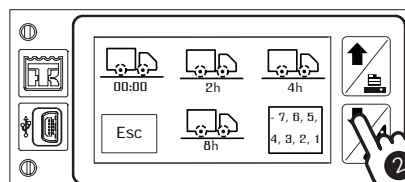
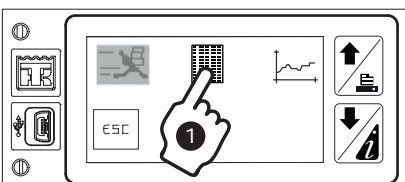

Midnight till now



Past 2 hours



Past 4 hours



Past 8 hours



Specific day from the past 7 days

4.2 Sélectionner Heures / Jours

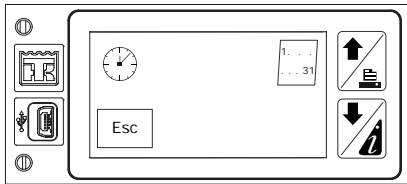

- Specific start time to present time
- Specific start and end date

4.3 Annuler l'impression

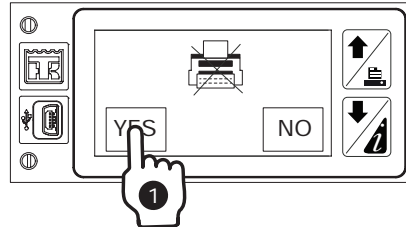
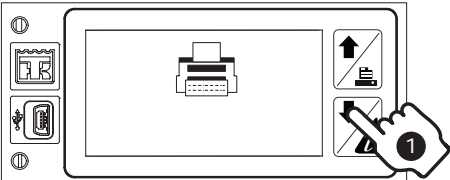

5. Imprimer / charger un trajet

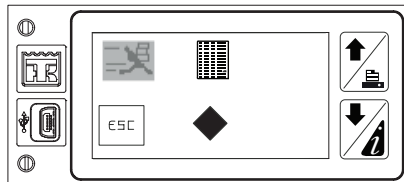
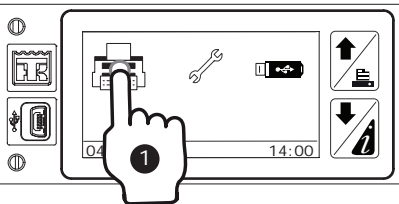

- Delivery Ticket
- Trip Ticket
- Download Previous Trip

6. Menu de l'utilisateur

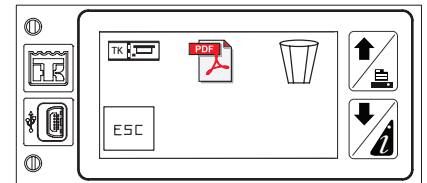
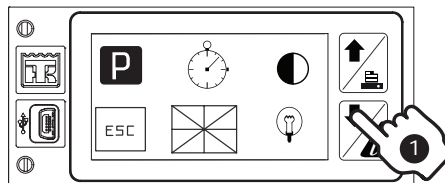
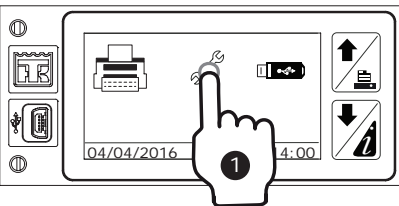

- Print by Date option
- Contrast
- Brightness
- Export in Pdf/ txt
- Data Transfer Interval
- Language
- Touchprint Firmware
- Delete Temporary Data Park

6.1 Activer / Désactiver l'impression par date

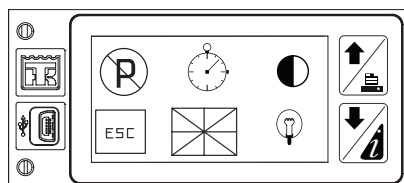
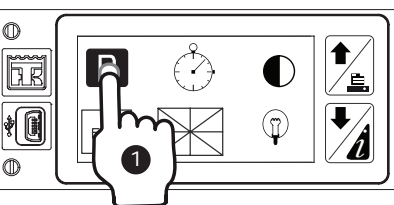

- Print by date option enable
- Print by date option disable

6.2 Programmer l'intervalle de transfert

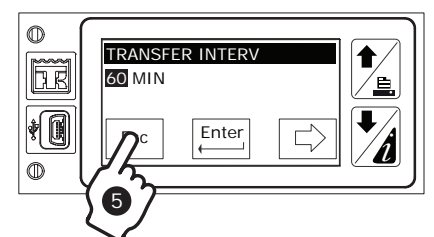
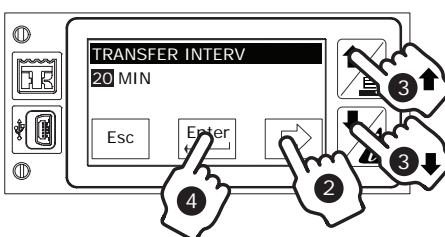
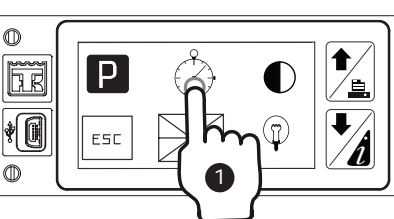

6.3 Changer le contraste

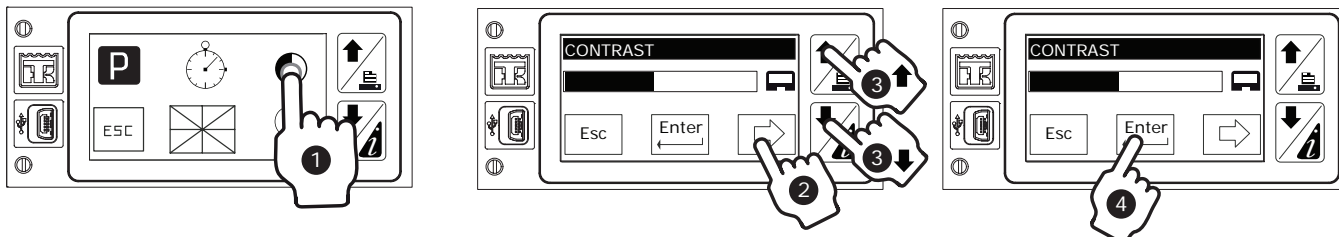

6.4 Changer la langue

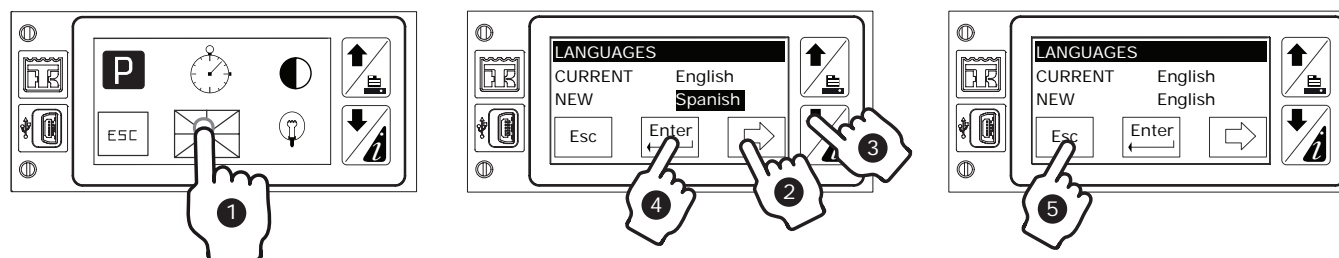

6.5 Changer le rétro-éclairage

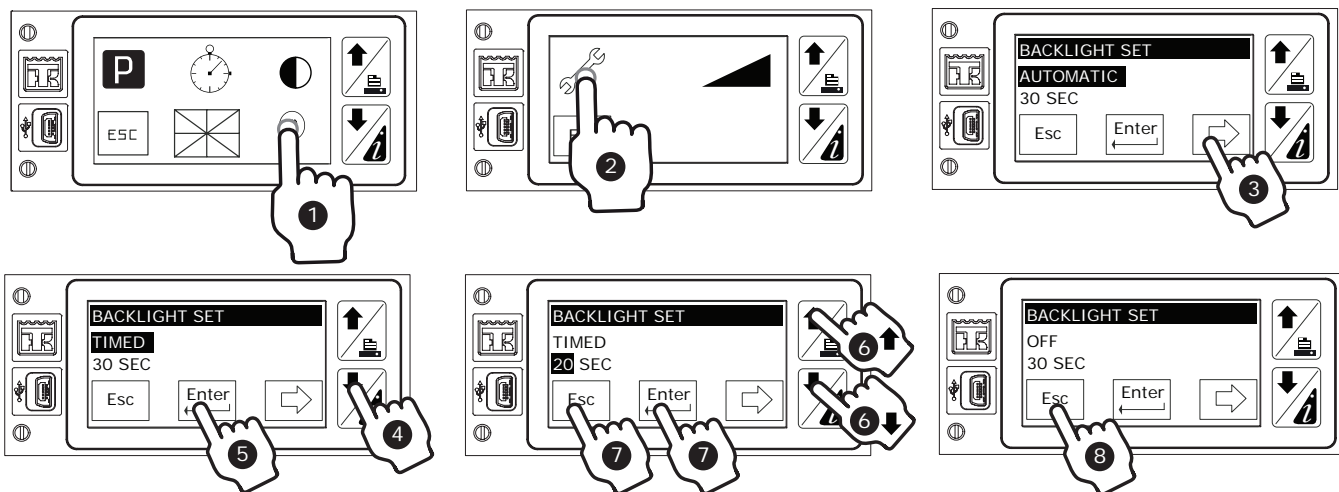

6.6 Changer la luminosité

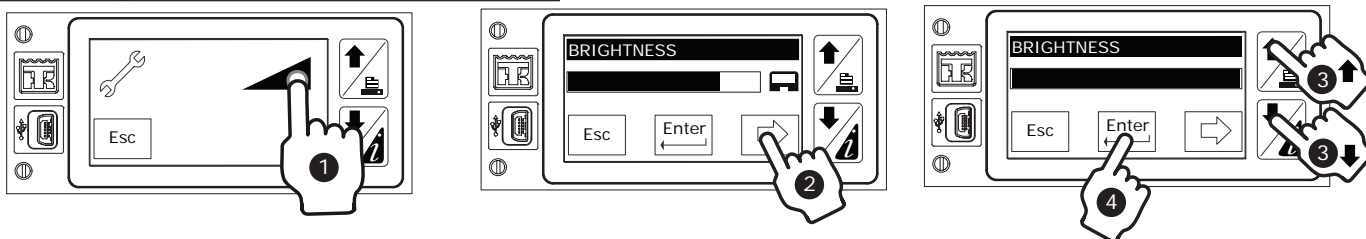

6.7 Exporter en format PDF ou TXT

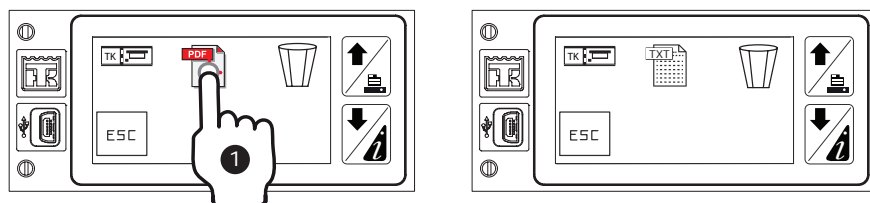

6.7 Effacer les données temporaires

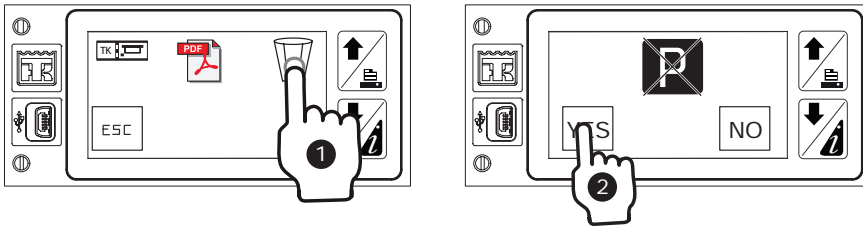

7. Opérations avancées

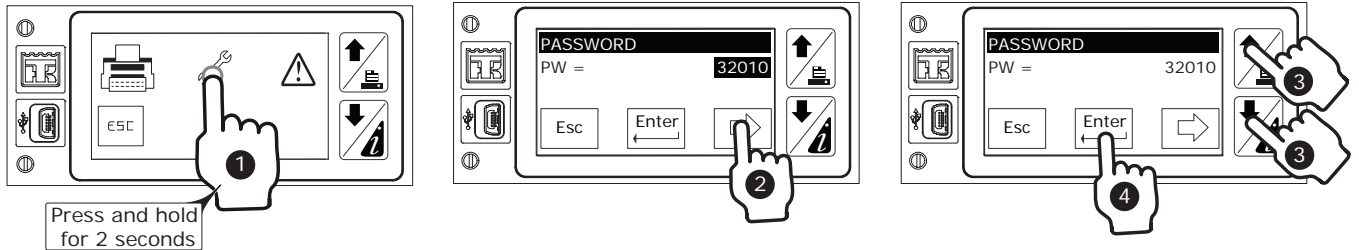

7.1 Menu d'entretien

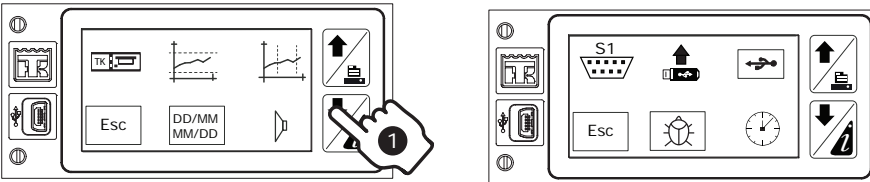

- Datalogger Model Name
- Temperature Range for Graph Printing
- Time Scale for Graph Printing
- Date Format
- Buzzer Sound
- UART Setting
- Firmware Update
- Wintrac Interface Via USB
- Adjusting the Time & the Date
- Debug Setting Parameter

7.2 Données de l'enregistreur

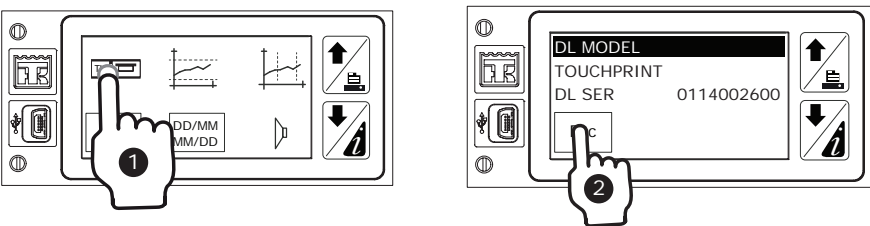

7.3 Plage de température pour les graphiques

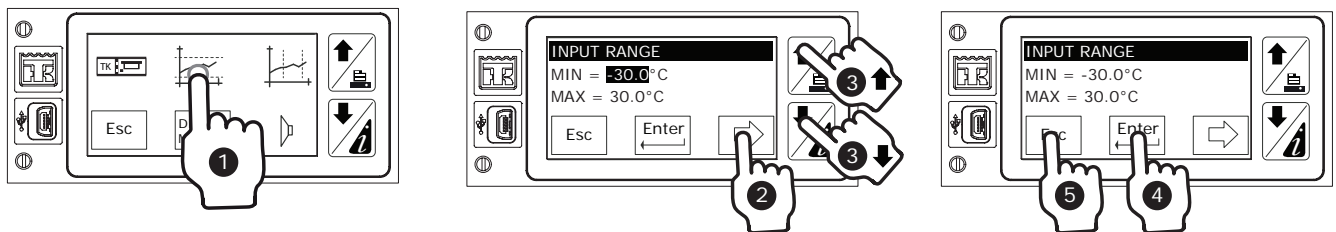

7.4 Echelle de temps pour les graphiques

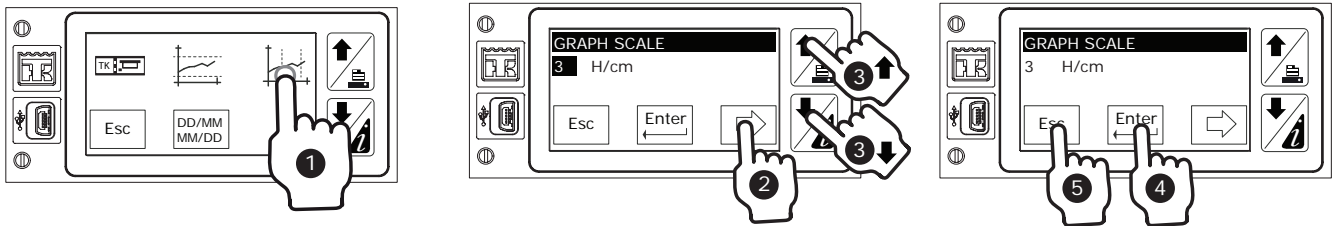

7.5 Format de la date

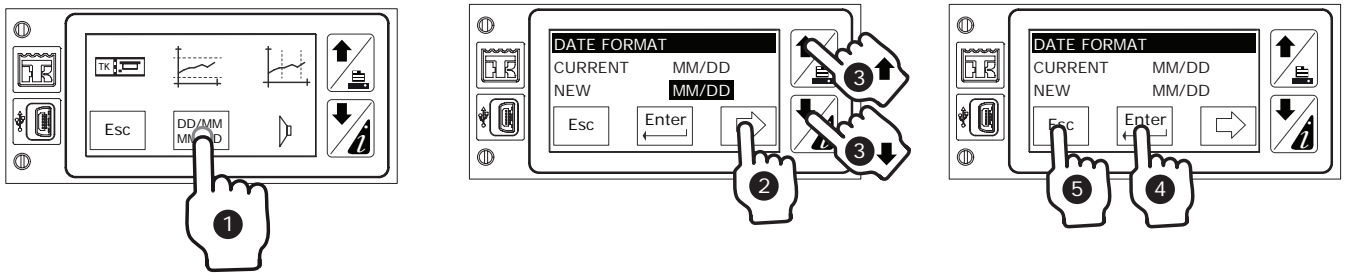

7.6 Activation de la sonnerie

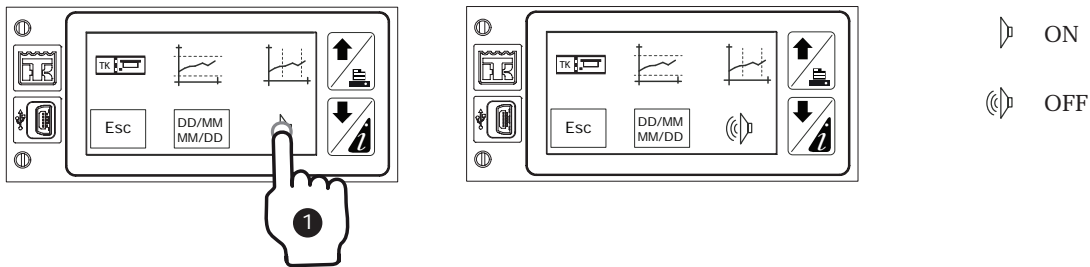

7.6 Configurer la communication

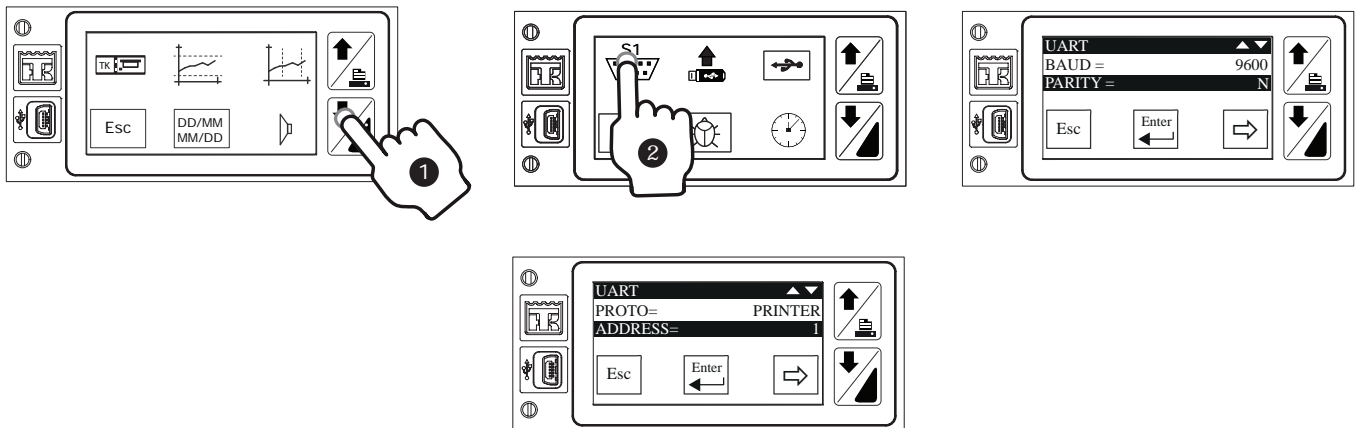

Note : The protocol should be Printer, and the Baud rate should be configured as per the datalogger settings, see the table.

Datalogger	DAS II	DAS IV	Cargo Watch
Supported Baud Rate	2400	2400, 9600	1200 TO 57600 (COM2 OF HMI)

Note : If the BAUD rate is not the same for HMI and TouchPrint, 'ERROR 6' will appear in the TouchPrint screen.

7.7 Mise à jour du Firmware

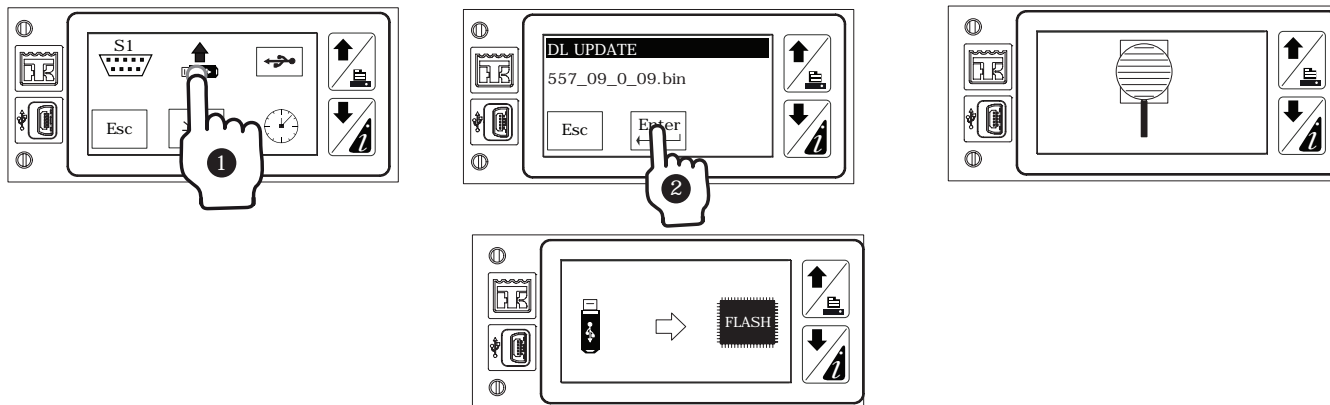

7.8 Configuration des paramètres

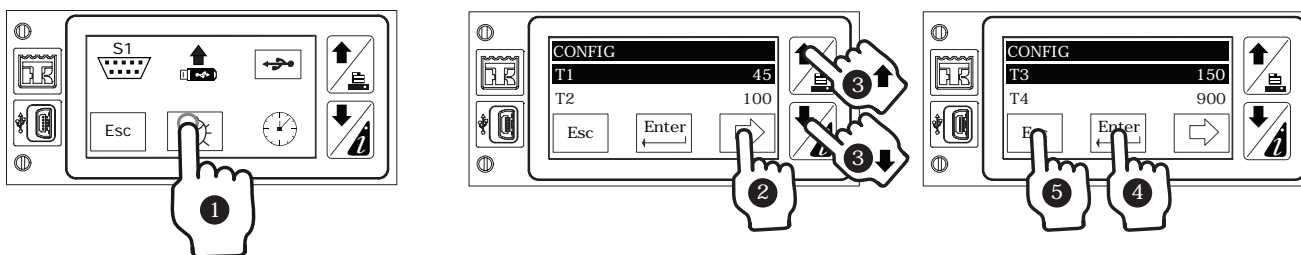

Note : Recommended Parameter Settings (Default).

- T1 = 45 sec,
- T2 = 100 sec,
- T3 = 150 sec,
- T4 = 1200 sec

7.9 Mettre à jour la date et l'heure

